

ORIJENTACIJA STANA U KOMPLEKSU

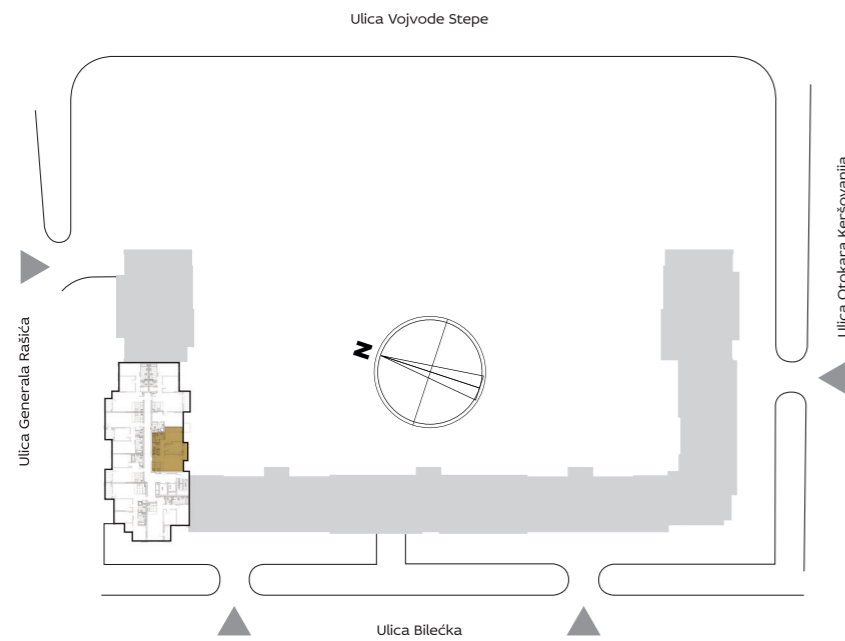

3D PRIKAZ STANA



ZGRADA

1

Trosoban stan

PROSTORIJE

1	ULAZ	2.97 m <sup>2</sup>
2	DNEVNA SOBA SA TRPEZARIJOM	18.86 m <sup>2</sup>
3	KUHINJA	3.82 m <sup>2</sup>
4.1	TOALET	2.29 m <sup>2</sup>
4.2	KUPATILO	5.06 m <sup>2</sup>
5.1	SPAVAĆA SOBA	13.66 m <sup>2</sup>
5.2	SPAVAĆA SOBA	10.02 m <sup>2</sup>
6.1	HODNIK	4.28 m <sup>2</sup>
<b>NETO STANA BEZ TERASE</b>		<b>60.96 m<sup>2</sup></b>
T1	TERASA	3.72 m <sup>2</sup>
<b>UKUPNO</b>		<b>64.68 m<sup>2</sup></b>

OSNOVA STANA

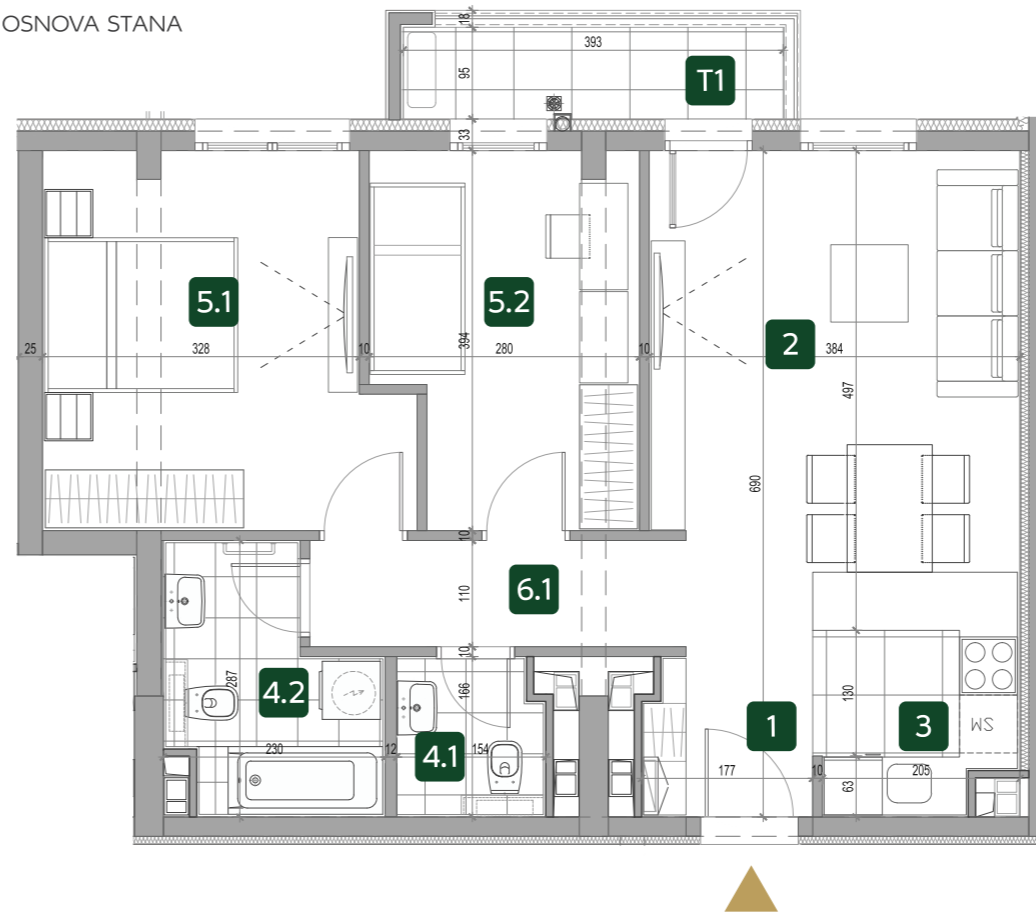

VIII

1.70