

ORIJENTACIJA STANA U KOMPLEKSU

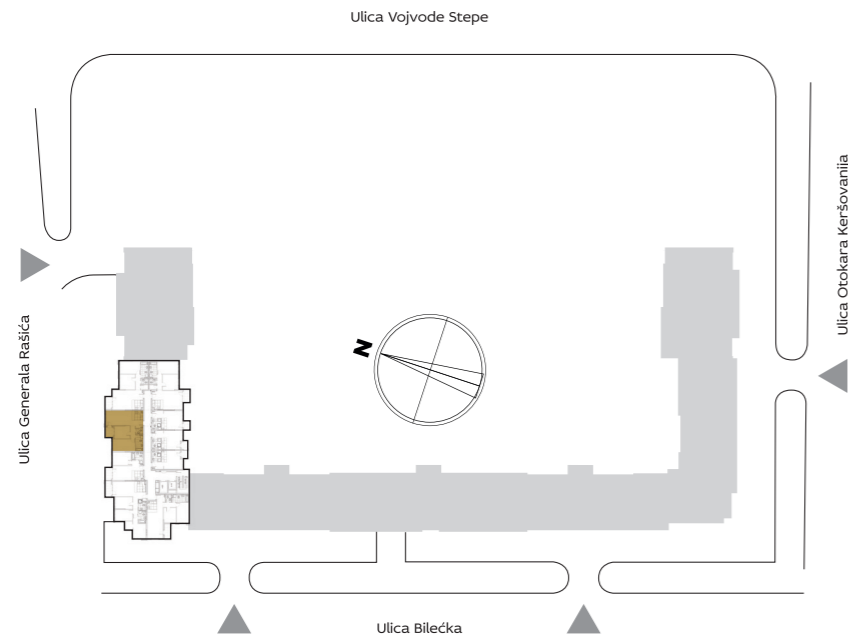

3D PRIKAZ STANA



OSNOVA STANA

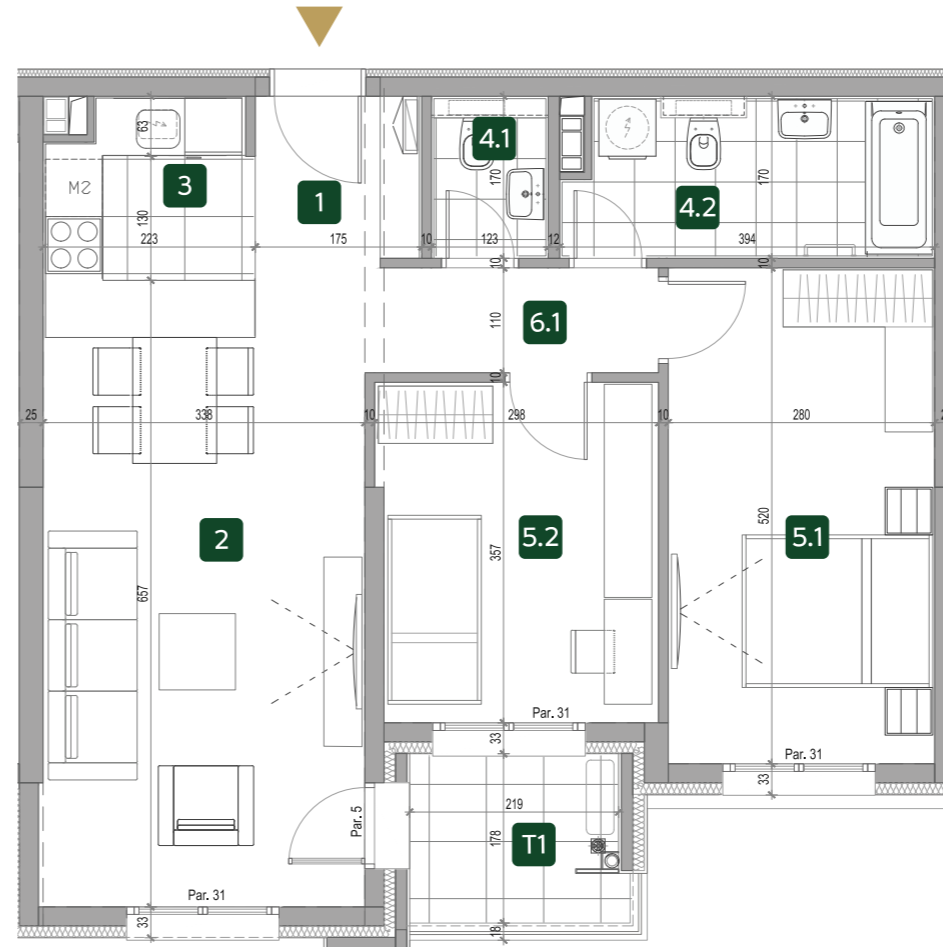

PROSTORIJE

1	ULAZ	4.54 m ²
2	DNEVNA SOBA SA TRPEZARIJOM	21.16 m ²
3	KUHINJA	3.94 m ²
4.1	TOALET	1.84 m ²
4.2	KUPATILO	6.22 m ²
5.1	SPAVAĆA SOBA	14.53 m ²
5.2	SPAVAĆA SOBA	10.39 m ²
6.1	HODNIK	3.21 m ²
NETO STANA BEZ TERASE		65.83 m²
T1	TERASA	3.91 m ²
UKUPNO		69.74 m²

ZGRADA

1

Trosoban stan

I 1.04

II 1.13

III 1.22

IV 1.31

V 1.40

VI 1.49

VII 1.58

VIII 1.67